

**SIOUX VALLEY DAKOTA NATION
INFRASTRUCTURE
SNOW & ICE CONTROL POLICY**

SIOUX VALLEY DAKOTA NATION
INFRASTRUCTURE
POLICY, PROCEDURES AND STANDARDS MANUAL

POLICY STATEMENT

Sioux Valley Dakota Nation is committed to safe passage of vehicles by ensuring snow and ice control is carried out on road under the direction, management of Infrastructure – Public Works.

Sioux Valley Dakota Nation snow and ice control program is to reduce snow and ice hazards to provide reasonable road safety and mobility under normal winter weather conditions. Sioux Valley Dakota Nation will ensure that roadways are reasonably maintained for winter driving in such a manner as to prevent or reduce accident and injury.

Snow and ice control operations will be managed in accordance with Council’s approval.

PUBLIC WORKS DEPARTMENTS OVERALL SNOW AND ICE CONTROL GOALS. WE WILL STRIVE TO:

- a. Monitor weather and road conditions twenty-four hours per day.
- b. Maintain roads in a safe driving condition.
- c. Perform snow removal and ice control tasks in a timely manner.

DEFINITIONS:

- 1) **“Emergency Access Routes”** means the roads that provide access to security station and fire hall.
- 2) **“Priority Routes”** mean routes & parking lots to businesses and entities.
- 3) **“Secondary Routes”** means the roads located within residential districts of Sioux Valley Dakota Nation as shown on the map attached as Schedule “A”.
- 4) **“Essential Service Routes”** means the roads that provide access to hospital for dialysis, main governance building and health centre.
- 5) **“Equipment”** means the equipment deployed by Sioux Valley Dakota Nation for Snow Control and Ice Control as listed under “Equipment and Operations”.
- 6) **“Extraordinary Weather Event”** means snowfall accumulation exceeding thirty (30) centimeter or 11-12 inches in dept or such other weather conditions, including, but not limited to freezing rain or flooding, the management of which will, in the sole discretion of the Director of Infrastructure & Public Works Heavy Equipment Lead Hand, exceed the budgetary or operational compacity of the Infrastructure Department.

- 7) **“Ice Control”** means the management of the build-up of packed snow or ice on the roads using Equipment, or sanding and salting.
- 8) **“Regular Operations Hours”** means 8 hours per day and does not include overtime, weekends or statutory holidays. Typically, this is 8:00 A.M to 5:00 P.M Monday through Friday; however, schedules may be shifted or adjusted so work required maybe completed.
- 9) **“Snow Control”** means the clearing of snow from roads including, but not limited to, snow plowing, blowing, hauling, and removal.
- 10) **“Snow Event”** means snowfall accumulation exceeding (10) centimeters or 4 inches.
- 11) **“Windrow”** means a continuous row or pile of snow left as a result of snow plowing on roadway.

PRIORITY FOR SNOW CONTROL:

Once a Snow Event has ended, Snow Control will be undertaken in the following roadway priority order:

- 1) **Priority 1:** Emergency Access Routes – completed within twenty-four (24) hours of the end of Snow Event.
- 2) **Priority 2:** Essential Service Routes – completed within twenty-four (24) hours of the end of a Snow Event.
- 3) **Priority 3:** Primary Routes - completed within twenty-four (24) hours of the end Snow Event.
- 4) **Priority 4:** Secondary Routes - completed within twenty-four (24) hours after all other priority routes (1-3) have been completed, unless service times and priorities are reset.

Snow Control priority and service times listed above may be impacted and altered, when necessary and at the discretion of the Director of Infrastructure or Public Works Heavy Equipment Lead Hand.

- 1) The temperature before, during or after a storm.
- 2) The duration of the storm.
- 3) The amount of accumulated snow.
- 4) The weather forecast.
- 5) Wind speed and direction.
- 6) Unforeseen equipment breakdowns; and
- 7) Requests by police, fire, ambulance or other emergency services.

A new Snow Event resets the priority and service times listed above.

SCHOOL ZONES AND DESIGNATED PICK -UP AREAS:

No Snow Control or Ice Control will occur at the school between the hours of 7:30 A.M. to 9:00 A.M and 2:30 P.M to 4:00 P.M to reduce the risk of pedestrian or vehicle accidents.

EQUIPMENT AND OPERATIONS:

Sioux Valley Dakota Nation uses the following equipment to implement this Policy:

- 1) Grader.
- 2) Vehicles equipped with a snowplow.
- 3) 2 bucket loaders or reactor blade.
- 4) Tandem truck.
- 5) Sander; and
- 6) Any other equipment as required or deployed by the Director of Infrastructure or Public Works Heavy Equipment Lead Operator.

DISPATCHING OF EQUIPMENT:

The start of snow and ice control operations for any storm is dependent upon immediate and anticipated conditions. Dispatching of equipment will be determined by the Director of Infrastructure or Public Works Heavy Equipment Lead Hand. Plowing and/or sanding operations may occur during regular work shift 8:00 A.M to 5:00 P.M. or on a specific situation call out. If the situation requires operators to respond other than their regular shift, the Director of Infrastructure or Public Works Heavy Equipment Lead Hand will contact the affected operators and contracted contractors.

Operators will be expected to work in excess of eight hours. The preferred shift is a maximum of 12 hours in a twenty – four-hour period. There may be instances when this will not be possible depending on the storm conditions or other circumstances.

SNOW CONTROL:

Once a Snow Event has ended, Snow Control will occur in the following manner:

- 1) Snow control equipment will warm up 30 minutes before beginning.
- 2) Priorities 1-4 to commence.
- 3) Snow removed from the roadways/parking lots will be hauled to an authorized snow storage site.

Snow in Sioux Valley Dakota Nation operated parking lots will be cleared and piled for removal when time permits.

WINDROWS AND STOCKPILED SNOW:

Windrows and other stockpiles of snow that occur as a result of Snow Control:

- 1) Pose a risk to public safety and shall not be stepped on, crossed, or played on by any persons.
- 2) May temporarily block driveways, access routes, lane entrances, and intersections. The Windrow will be cleared by Sioux Valley Dakota Nation as soon as is practical.

During an Extraordinary Weather Event, Windrows may be left in any manner as directed by the Director of Infrastructure or Public Works Heavy Equipment Lead Hand.

ICE CONTROL:

Ice Control is performed, when necessary, may occur in conjunction with Snow Control, or may be done independently, and will utilize the same priority routes identified above for snow control.

Ice Control will be initiated by the Public Works Heavy Equipment Lead Hand when snowfall accumulation is less than five (5) centimeters, and the temperature and conditions are conducive for the formation of ice on the roads.

Ice Control will consist of:

- 1) Dispensing of a salt/sand mixture of 4:1 at major intersections and areas of concern, including, but not limited to, hills and curves.
- 2) Clearing of packed snow and ice from roads using the methods described in the Snow Control Section of this Policy.

EXTRAORDINARY WEATHER EVENT:

During an Extraordinary Weather Event, the Director of Infrastructure may:

- 1) Hire, engage and deploy any resources, if available, including third-party contracted services.
- 2) Direct that Snow Control and Ice Control occur in any manner deemed appropriate notwithstanding the priority procedures in this Policy.

SPRING MELT PREPARATIONS:

Preventative measures will be taken to mitigate flooding risks during spring melt. These measures include, but are not limited to, removal of excessive amounts of snow in drainage, ditches, or other key areas, and the de-icing of culverts using steaming techniques.

COMMUNICATION TO THE PUBLIC:

The Sioux Valley Dakota Nation Website and Radio Station will be used to notify the public of Snow Control in advance.

The Director of Infrastructure is responsible for implementing this Policy and must:

- 1) Ensure Equipment operators have the required training prior to operating Equipment independently.
- 2) Commence the operations of Snow Control and Ice Control.
- 3) Manage the use of contracted services and staff overtime and may make requests to the Portfolio Holders for additional resources, if required.

- 4) Adjust working hours to consider snow and road conditions. This may include starting personal earlier to avoid high traffic and business operating hours.

SANDING:

To save the environment and to remain cost effective, the Sioux Valley Dakota Nation policy will be to provide an abrasive surface at intersections of collector/arterial streets, residential streets and hills. The abrasive mixture will normally be a mixture of washed sand and salt, with salt making up approximately 5% of the mixture. This provides for traction but is not intended to provide a bare pavement during winter conditions. Normally sanding will only commence after plowing has occurred, however, due to safety reasons, sanding may be required before plowing occurs.

PROPERTY DAMAGE:

Sioux Valley Dakota Nation recognizes that on occasion private property is damaged during snow and ice control operations. Examples: Fences, vehicles, trailers, landscaping, trees and gardens, etc.

Sioux Valley Dakota Nation will not repair private landscaping. Example: trees, gardens, sod, etc. Where this happens, it will be the policy of Sioux Valley Dakota Nation to handle the damages in the following manner:

- 1) Director of Infrastructure, or designee shall investigate complaints of damage. If evidence indicates that physical contact occurred between the plow and Property of Sioux Valley Dakota Nation may assume responsibility for repair.

COMPLAINTS AND REQUESTS FOR FURTHER SERVICES:

Complaints and requests for further services regarding snow and ice control or damage will be taken during normal working hours. Complaints and requests for further service should be directed to Infrastructure front desk. Complaints and requests for further service will be handled on a priority basis. Response time should not exceed 24 hours after the snow has ceased unless conditions or operations prevent the Director of Infrastructure from responding. It should be understood that responses are to ensure that the provisions of this policy have been fulfilled and that all the residents have been treated fairly.

REVIEW OF POLICY:

Sioux Valley Dakota Nation will keep on file comments and complaints received regarding this policy. This policy will be reviewed periodically. Any review will consider comments received since the last review.

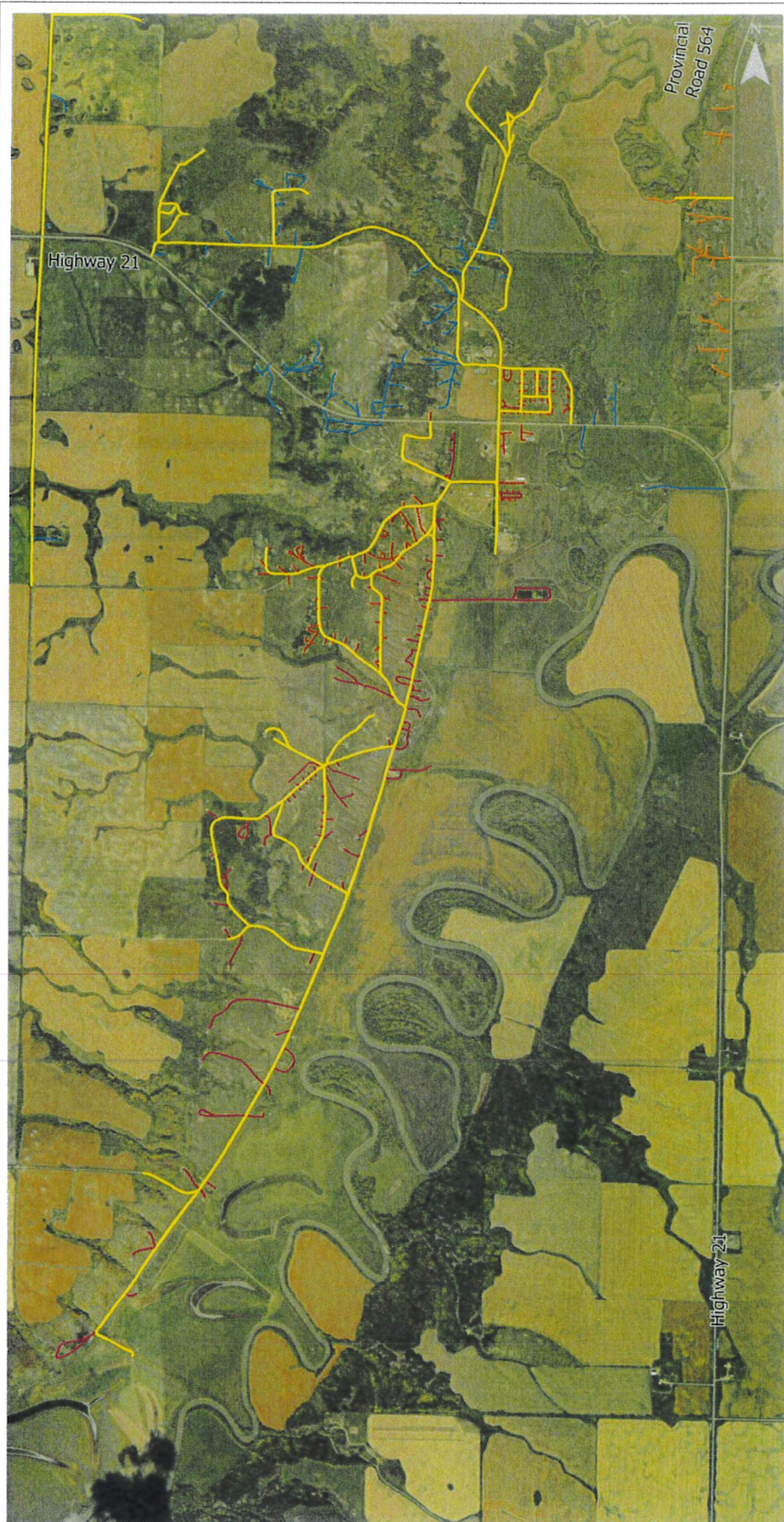

Sioux Valley Dakota Nation
2023 Snow Clearing Route

- GRADER
- PLOW TRUCK
- LOADER
- D.O.L. Tractor
- BACKHOE/SKIDSTEER

